



environmental affairs

Department:
Environmental Affairs
REPUBLIC OF SOUTH AFRICA



DEPARTMENT OF ENVIRONMENTAL AFFAIRS
REPUBLIC OF SOUTH AFRICA

P/ Bag X447, Pretoria, 0001, Tel: (+27 12) 310 3539, Fax: (+27 12) 310 3500
Website: www.deat.gov.za
Enquiries: J A Dreyer
Email: adreyer@deat.gov.za
File: A15/1/2/1/1

Chief Director: MCM - Research, Antarctica and Islands
Master: mv SA Agulhas
Participating Group Leaders

SAILING INSTRUCTIONS MV SA AGULHAS: ANTARCTICA (SANA E) 9 DECEMBER 2009 - 18 FEBRUARY 2010

- A. ORGANISATION OF OPERATIONS AND CONDUCT OF PARTICIPANTS IN THE SOUTH AFRICAN NATIONAL ANTARCTIC PROGRAMME (SANAP)
1. This document outlines formal policy on organisation of operations and conducts of participants in the SANAP voyages, whether these participants are on board the S.A. Agulhas or any other vessel on a SANAP operation and at bases, and is issued in the interest and well being of all.
 2. A Departmental Co-ordinating Officer-in-Charge (DCO), nominated by the Department of Environmental Affairs (DEA) will assume overall responsibility for co-ordinating the voyage activities, projects, personnel and discipline onboard the vessel and at the base stations. Whilst the Master of the vessel is responsible for the safety and well being of the vessel and all persons aboard in terms of the S.A. Merchant Shipping Act, the DCO will be responsible for ensuring that the voyage instructions are carried out efficiently and effectively. He will achieve this by regular discussions with the recognised Group Leader of each group e.g. the Helicopter Company, NDPW, Scientists, Master, Expedition Leaders, etc. These Group Leaders shall be nominated by their own organisation before the vessel's departure and the DCO will keep the Master fully informed of the day's plans and arrangements where the vessel is involved.
 3. Each Group Leader will be responsible for the well-being and conduct of his/her team. Any problems, complaints, reports of misbehaviour, etc. aboard the vessel or at the base stations/field camps are to be dealt with by the relevant Group Leaders, through or in consultation with the DCO. In the case of persons aboard the vessel, they are NOT to approach the Master directly regarding such matters and *vice versa*. Nothing less than normal, civilised, home standards of self-discipline and respect for others will be expected throughout the period of absence from South Africa. The Master is responsible for the conduct of the vessel's officers and crew.

PASSENGER LIST: SANAE 2009/2010

DEPARTMENT OF ENVIRONMENTAL AFFAIRS (DEA)

Departmental Co-ordinator (DCO)	- Mr. JA Dreyer
Assistant DCO & Technical Officer	- Mr. G van Zyl
Safety Officer & Trainee ADCO	- Mr. G Magagula
Administration Officer & Trainee DCO	- Me. C Phamoli
General Technician	- Mr. M Salmani
Journalist	- Me. T Walters
Chef	- Mr. M Bacon
Chef	- Me. S Browning
Environmental Officer	- Mr. T Mulaudzi
Chaplain	- Cpln. (Me.) N Herbst
Barlows Diesel Mechanic	- Mr. J Fourie
Dozer Machine Operator	- Mr. K Cronje
Driver/Diesel Mechanic & Group Leader	- Mr. DGH Grundling
Driver/Diesel Mechanic	- Mr. M Estrehuyzen
Driver/Diesel Mechanic	- Mr. A Kietzman
Driver/Diesel Mechanic	- Mr. CPJ Groenewald
Driver/Diesel Mechanic	- Mr. A Minnaar

NATIONAL DEPARTMENT OF PUBLIC WORKS (NDPW)

Group Leader	- Mr. A Rocha
	- Mr. D du Toit
	- Mr. W vd Westhuizen
	- Mr. S Humdulay
	- Mr. S Mahanjana
	- Mr. A Hendricks
	- Mr. G Williams
	- Mr. N Dike
	- Mr. P Kleinhans
	- Mr. P Morta
	- Mr. W Samsodien
	- Mr. J Coert
	- Mr. P Nel

HELICOPTER SUPPORT (TITAN HELICOPTERS)

Group Leader	- Capt. D Hilland
	- Capt. R Penhall
	- Capt. B Barnard
	- Mr. B Wessels
	- Mr. J Britton
	- Mr. JA Brophy
	- Mr. D Jordaan
	- Mr. C vd Merwe
	- Me B Hilland
	- Mr. E Yekanie
	- Mr. D Filhalani
	- Mr. T Botha

OUTSITE NMII (DECOMMISSIONING OF NEUMAYER II STATION)
Group Leader

- Mr. HR Stassen
- Mr. L du Plessis
- Mr. J Juterbock
- Mr. J Wallace
- Mr. RJ Duncan
- Mr. P Loots
- Mr. SM Bezuidenhout
- Mr. RDF Stassen
- Mr. P Kruger
- Mr. E de Beer
- Mr. A Nortje
- Mr. R Wyss
- Mr. J Wessels
- Mr. WH Boshoff
- Mr G Kotze
- Mr. J van Graan
- Me. A du Plessis (down voyage only)
- Me. SL Clark (down voyage only)

SCIENTISTS: -

UNIVERSITY OF PRETORIA (GEOGRAPHY, GEOFORMATICS and METEOROLOGY)

- Science Coordinator & Group Leader (SANAE based)
- Prof. I Meiklejohn
 - Dr. J Lee

SOUTH AFRICAN WEATHER SERVICE (SAWS)

Group Leader

- Mr. Q Jacobs
- Me. S Linnerts

NORTH WEST UNIVERSITY (COSMIC RAYS)

Group Leader

- Mr. M O'Kennedy

UNIVERSITY OF KWAZULU – NATAL (AMIGO)

Group Leader

- Me. D Koch
- Me. M van Zyl
- Me. H Dahlgren
- Mr. T Sundberg

HERMANUS MAGNETIC OBSERVATORY (SHARE HF RADIO)

Group Leader

- Me. S Bremner
- Mr. SJ van der Merwe

HERMANUS MAGNETIC OBSERVATORY (POLAR SPACE WEATHER PROJECT)

- Me. J de Bruyn
- Mr. C Ngwira

UNIVERSITY OF STELLENBOSCH (ELECTRICAL MACHINES LABORATORY)

Group Leader

- Mr. A Lombard
- Mr. J Potgieter
- Mr. I Hobbs

VOYAGE 148 SCHEDULE

SA AGULHAS - SANAE 2009/10

PRE-DEPARTURE DETAILS

5 & 6 December 2009 (weekend)	Bunker fuel for SANAE and helicopters	2 Days
1 December 2009 - 4 December 2009	Load all cargo	4 Working days
4 December 2009	Load vehicles	1 Day
7 December 2009	Load NMI frozen items into ship's freezers & cold room	0,5 Days
8 December 2009	Load 2 x SANAP reefer containers Helicopters onboard	1 Day
9 December 2009	12:00 All passengers onboard Vessel departs at 14:00	

VOYAGE DETAILS

DEPARTURE	ARRIVE	ACTION	DURATION
9 December 2009 (ETD Cape Town 14h00)	21-22 December 2009 (ETA RSA Penguin bukta)	> Voyage to Antarctica, RSA Penguin bukta area > Inspection team flown to SANAE, helicopter will return to ship once at Atka bukta	12-13 Days 0,5 Days
21-24 December 2009 – 22-25 December 2009		> Voyage to Atka bukta	1-3 Days
22-25 December 2009 – 25-30 December 2009 (Atka bukta)		> Offload Outside containers & cargo > Off-load SANAP cargo & drivers > First cat trains depart for SANAE > Fly passengers to SANAE	4 - 6 Days
26-31 December 2009 (ETD Atka bukta)	27 Dec09 – 1 Jan 10 (ETA Penguin bukta)	> Sail to Penguin bukta	2 Days
27 Dec09-02 Jan 10 - 01-07 Jan10 (at Penguin bukta)		> Discharge all bunker fuel for SANAE base > One helicopter ship-based during fuel pumping	6 Days
Approx 08 Jan10 – approx 1 Feb10		> SAWS buoy deployment, South Thulie Island, South Georgia & oceanographic cruise– ship to return directly to Atka bukta	Max 22 - 24 Days
2 Feb10 - 8 February 2010 (Atka bukta)		> Packing containers > Transport cargo to Atka bukta > All returning vehicles & reefers to Atka bukta > Back-load SANAP cargo from Atka bukta > Back-load Outside cargo > Back-load passengers	7 Days
Approx 8 February 2010 (ETD Atka bukta)	18 February 2010 (ETA Cape Town)	> Voyage to Cape Town	10 Days

TOTAL DURATION OF RELIEF VOYAGE (CT - CT)

- 72 DAYS

PASSENGER CABIN ALLOCATION

VOYAGE NUMBER 148

9 December 2009

FROM

Cape Town

TO:

Antarctica

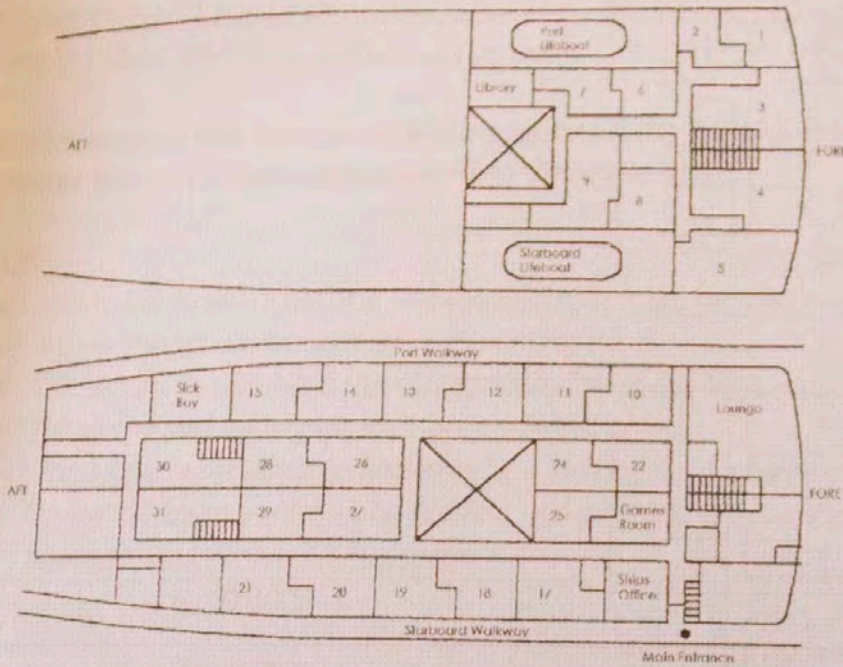

		NAME	No	NAME	No	NAME	No	NAME	No	
1	a	G V ZYL	10	a	T SASSEN	17	a	C VD MERWE	24	
	b	A ROCHA		b	J HAYES		b	B WESSELS		
2	a	JA DREYER	11	c	M MANKO	18	c	JA BROPHY	25	
3	a	S THOMALLA		d	R VAN SHIE		d	E YEKANIE		
	b	J DE BRUYN		a	E KRUGER		a	P HAYES-FOLEY	26	
	c	S BREMNER		b	R JORDAAN		b	M BACON		
d	D KOCH	c	R SCHOEMAN	c	A MINNAAR					
4	a	D HILLAND	12	d	J NORTJE	19	d	SJ VD MERWE	27	
	b	B HILLAND		a	C SMITH		a	A LOMBARD		
	c	D FILHALANI		b	S NICHOLSON		b	J POTGIETER		
	d	T BOTHA		c	T WALTERS		c	I HOBBS		
5	a	I MEIKLEJOHN	13	d	M VAN ZYL	20	d	J STANDER	28	
	b	RJ SCHOLES		a	P NEL		a	A HARRINGTON		
	c	Y COTRONEO		b	H VD WESTHUIZEN		b	S BROWNING		
	d	Q JACOBS		c	D DU TOIT		c	F PRESTON-WHYTE		
6	a	L CLARK	14	d	P KLEINHANS	21	d	S MAXWELL-HAFEN	29	
	b	A HARMS		a	DGH GRUNDLING		a	A NORTJE		
7	a	C PHAMOLI	15	b	M ESTERHUIZEN	22	b	J WALLACE	30	
8	a	HR STASSEN		c	CPJ GROENEWALD		c	SM BEZUIDENHOUDT		
	b	RDF STASSEN		d	A KIETZMAN		d	P LOOTS		
	a	R PENHALL		a	W SAMSODIEN		a	J JUTERBOCK		
9	b	B BARNARD	16	b	S HAMDULAY	23	b	SL CLARK	31	
	c	J BRITTON		c	A HENDRICKS					
	d	D JORDAAN		d	G WILLIAMS					
24			24		22			24	d	P MORTA

N HERBST & J LEE (share) and S LINNERTS - 2 cabins at officers deck no 1.

22
24
24
94
3
27

PASSENGER CABIN ALLOCATION

VOYAGE NUMBER : 148 Approx 8 Feb 2010 FROM Antarctica TO: Cape Town

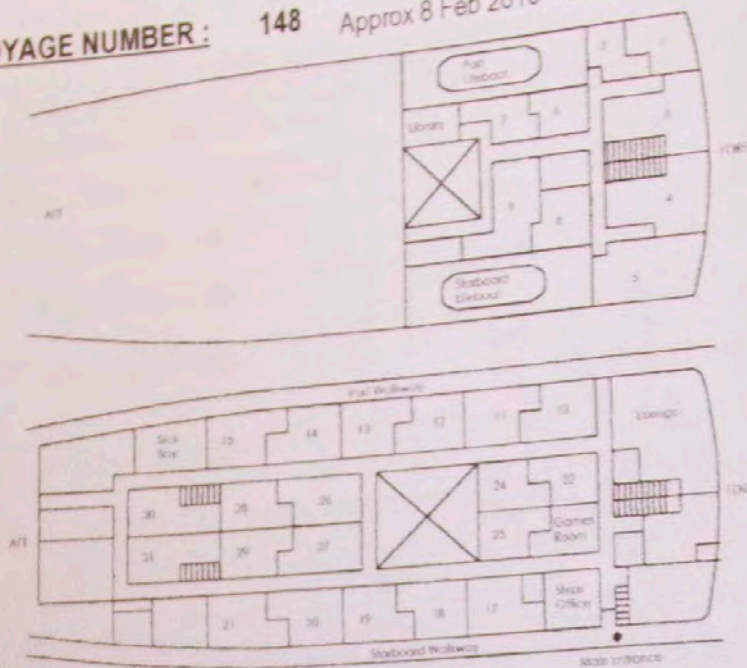

No	NAME	No	NAME	No	NAME	No	NAME	
1	a C PHAMOLI	10	a W NEL	17	a C VD MERWE	24	a L DU PLESSIS	
	b J LEE		b E MINNIE		b JA BROPHY		b R DUNCAN	
2	a JA DREYER		c A HUANG		c E YEKANIE	d B WESSELS	25	a M SALMANI
			d K BROWN		a P HAYES-FOLEY	b G MAGAGULA		
3	a S THOMALLA	11	a Y COTRONEO	18	a A NORTJE	26	a M BACON	
	b J DE BRUYN		b C VAN AARDT		b P LOOTS		b J JUTERBOCK	
	c S BREMNER		c R MEYER		c G KOTZE		c A MINNAAR	
	d D KOCH		d J FOURIE		d A LOMBARD		d M O'KENNEDY	
4	a D HILLAND	12	a C SMITH	19	a J POTGIETER	27	a SM BEZUIDENHOUDT	
	b B HILLAND		b S NICHOLSON		b I HOBBS		b P KRUGER	
	c D FILHALANI		c T WALTERS		c J STANDER		c E DE BEER	
	d T BOTHA		d M VAN ZYL		d A HARRINGTON		d J VAN GRAAN	
5	a I MEIKLEJOHN	13	a P NEL	20	a N HERBST	28	a K CRONJE	
	b RJ SCHOLES		b H VD WESTHUIZEN		b S MAXWELL-HAFEN		b J FOURIE	
	c A ROCHA		c D DU TOIT		d F PRESTON-WHYTE		a H DAHLGREN	
	d Q JACOBS		d P KLEINHANS		a J WESSELS		b T SUNDBERG	
6	a J THIRSK	14	a DGH GRUNDLING	21	a J WALLACE	30	a SJ VD MERWE	
	b S BROWNING		b M ESTERHUIZEN		b R WYSS		b T MULAUDZI	
7	a G V ZYL		c CPJ GROENEWALD		c A KIETZMAN		d WH BOSHOF	c T MTSHALI
			d A		a W SAMSODIEN		a L KOCK	d C NGWIRA
8	a HR STASSEN	15	b S HAMDULAY	22	b N GREEN	31	a G WILLIAMS	
	b RDF STASSEN		c A HENDRICKS				b N DIKE	
9	a R PENHALL		d J COERT				c S MAHANJANA	
	b B BARNARD						d P MORTA	
	c J BRITTON							
	d D JORDAAN							

S LINNERTS - 1 cabin at officers deck no 1.