



environment & tourism

Department:
Environmental Affairs and Tourism
REPUBLIC OF SOUTH AFRICA

**DEPARTMENT OF ENVIRONMENTAL AFFAIRS AND TOURISM
REPUBLIC OF SOUTH AFRICA**

P/ Bag X447, Pretoria, 0001, Tel: (+27 12) 310 3539, Fax: (+27 12) 310 3500
Website: www.deat.gov.za

Enquiries: J A Dreyer
Email: adreyer@deat.gov.za
File: A15/1/2/1/1

Chief Director: MCM - Antarctica and Islands
Master: *mv SA Agulhas*
Participating Group Leaders

**SAILING INSTRUCTIONS: MV SA AGULHAS: ANTARCTICA (SANAE)
23 DECEMBER 2008 - 5 MARCH 2009**

1. The *mv S.A. Agulhas* will depart from Cape Town harbour on 23 December 2008 at 14:00 on her annual relief voyage to Antarctica.
2. The following documentation are attached for your information and further attention:
 - voyage schedule (Annexure A)
 - passenger list (Annexure B)
 - cabin allocations (Annexure C))
 - SANAP base rules (Annexure E)
 - Organisation of Operations and Conduct of Participants in the South African Antarctic Programme (Annexure F)
 - Conditions for the use of the inflatable dinghy (Annexure G)

3. **TRAVEL DOCUMENTS**

All persons accompanying the voyage must be in possession of valid passport and residence or visitor's permits where applicable. The afore-mentioned documents must be handed to the ship's Catering Officer (Purser) minimum 24 hours prior to departure. Persons not complying with this request will be responsible for arranging their own customs and immigration clearance. All passport details are to be forwarded to Mr. Godfrey Magagula on or before 8 December 2008 to arrange for immigration clearance. Those participants, whose details have not been received, will be responsible for their own immigration/customs clearance. The ship will not be delayed for these purposes.

PASSENGER LIST

PERSONNEL SANAE 2008/2009**DEPARTMENT OF ENVIRONMENTAL AFFAIRS AND TOURISM (DEAT)**

Departmental Co-ordinator (DCO)	- Mr. JA Dreyer
Assistant DCO & Technical Officer	- Mr. G van Zyl
Administration Officer	- Mr. G Magagula
General Technician	- Mr. M Salmani
Chef	- Mr. J Gusha
Chef	- Me M Quellmalz
Environmental Officer	- Me. CA Jacobs
Structural Engineer	- Mr. HR Stassen
Architect	- Mrs. H Stassen
Chaplain	- Rev S Rangwaga

Mechanical/logistics personnel (DEAT)

Group Leader & Dozer Machine Operator	- Mr. LSD du Plessis
Dozer Machine Operator	- Mr. Mr K Cronje
Driver/Diesel Mechanic	- Mr. DGH Grundling
Driver/Diesel Mechanic	- Mr. M Esterhuyzen
Driver/Diesel Mechanic	- Mr. KG Mahlangu
Driver/Diesel Mechanic	- Mr. FT Thebe
Driver/Diesel Mechanic	- Mr. GA Harper
Barlows Vehicle Technician	- Mr. CJ Fourie

NATIONAL DEPARTMENT OF PUBLIC WORKS (NDPW)

Group Leader	- Mr. GEG Louw
	- Mr. GH Smith
	- Mr. A Schutte
	- Mr. E Bizaare
	- Mr. IS van der Berg
	- Mr. W Nontsency
	- Mr. M Jumba
	- Mr. A Rasdien
	- Mr. J Coert
	- Mr. B van Loggenberg
	- Mr. WH van der Westhuizen
	- Mr. D Damster

HELICOPTER SUPPORT (TITAN HELICOPTERS)

Group Leader	- Capt .D Hilland
	- Capt. N Ellis
	- Capt. K Ellis
	- Mr. B Wessels
	- Mr. J Britton
	- Mr. H Steyn
	- Mr. M Alexandroi

- Mrs. B Hilland
- Mr. C van der Merwe
- Mr. M Schwarze

SCIENTISTS: -

UNIVERSITY OF KWAZULU – NATAL (AMIGO)

Group Leader

- Me. S Bremner - Science Coordinator station-based
- Mr. B Delpont
- Mr. E Koen

HERMANUS MAGNETIC OBSERVATORY (SHARE HF RADIO)

Group Leader

- Mr. L Magnus
- Mr. K Maphaha
- Mr. P Sibanda
- Mr. S Mthembu

HERMANUS MAGNETIC OBSERVATORY (SANAP IPY PROJECT)

Group Leader

- Prof. S Pillay
- Mr. Z Mtumela

UNIVERSITY OF PRETORIA (GEOGRAPHY, GEOFORMATICS and METEOROLOGY)

Group Leader

- Mr. J le Poux
- Mr. M Laubser

UNIVERSITY OF CAPE TOWN (OCEANOGRAPHY)

Group Leader

- Me. Z Gebhardt - Science Coordinator ship-based
- Me. S Rainier
- Me. M Smith
- Mr. M Commins
- Mr. D Weir

UNIVERSITY OF CAPE TOWN (DEPT OF OCEANOGRAPHY)

Group Leader

- Dr. S Thomalla
- Dr. S Woodbourne
- Mr. M J Bibberd
- Me. E Kean

I-TASC – (RECONNAISSANCE and COMMUNICATIONS EXPIDITION)

Group Leader

- Mr. S Ngwenya
- Mr. F Valdes
- Mr T Mulcaire – **return voyage only**

SOUTH AFRICAN WEATHER SERVICE (SAWS)

Group Leader

- Mr. F Jeffrey
- Mr. L Fernandez

INTERNATIONAL SCIENTISTS

Brazilian

Brazilian

- Mr. R Burgo
- Me. L Collares

OVER-WINTERING TEAM – SANAE 48 (down voyage only)

Electrical Engineer & Team Leader	- Mr. L Kock
Mechanical Technician	- Mr. W Nel
Electronic Engineer	- Mr. A Huang
Diesel Mechanic & take-over Transport Officer	- Mr. N Green
Diesel Mechanic	- Mr. C van Aardt
Doctor	- Dr. (Me.) J Thirsk
Scientist	- Mr. E F Minnie
Scientist	- Mr. K R T Browne
Scientist	- Mr. R G V Meyer
Meteorologist	- Mr. J Jamneck

OVER-WINTERING TEAM – SANAE 47 (return voyage only)

Doctor & Team Leader	- Dr. R. Hofmeyr
Mechanical Engineer	- Mr. A P van Zyl
Electrical Engineer	- Mr. S Nginda
Electronic Engineer	- Mr. G J Laubscher
Diesel Mechanic	- Mr. C Fourie
Diesel Mechanic	- Mr. R J Duncan
Scientist	- Mr. M R O'Kennedy
Scientist	- Mr. L. Kriedemann
Scientist	- Me. D. Koch
Meteorologist	- Me. H.S. du Toit

Annexure C

PASSENGER CABIN ALLOCATION

VOYAGE NUMBER 144 23 December 2008 FROM Cape Town TO: Antarctica

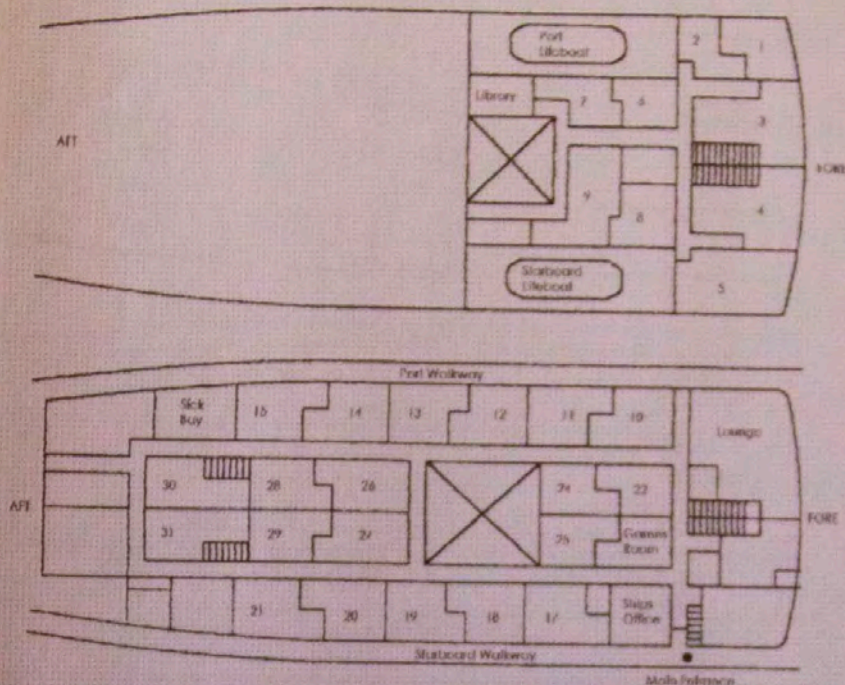

		NAME	No	NAME	No	NAME	No	NAME	No	
1	a	L MAGNUS	10	a	LSD DU PLESSIS	17	a	J BRITTON	24	
	b	S PILLAY		b	K CRONJE		b	D JORDAAN		
2	a	JA DREYER	11	c	GDH GRUNDLING	18	c	C VD MERWE	25	
3	a	Z GEBHARDT		d			d			a
	b	S BREMNER	a	EF MINNIE	a	M ALEXANDROI	b	L FERNANDEZ		
	c	S THOMALLA	b	KRT BROWNE	b	M SCHWARZE	c	K MAPHAHA		
4	d		c	RGV MEYER	c	H STEYN	d	P SIBANDA		
	a	D. HILLAND	d	A HUANG	d		c	S MTHEMBU		
	b	B. HILLAND	a	N GREEN	a	G MAGAGULA	d	S RANGWAGA		
	c		b	W NEL	b	M SALMANI	a	S NGWENYA		
5	d		c	J JAMNECK	c		b	F VALDES		
	a	GEG LOUW	d		d		c	Z MTUMELA		
	b	GH SMITH	a	IS VD BERG	a	S RAINIER	d			
	c	B V LOGGENBERG	b	A SCHUTTE	b	M QUELLMALZ	a	E BIZAARE		
6	d		c	H VD WESTHUIZEN	c	M SMITH	b	A RASDIEN		
	a	CA JACOBS	d	D DAMSTER	d	E KEAN	a	L COLLARES		
7	b	J THIRSK (DR)	a	M COMMINS	a	R BURGO	b			
	a	G VAN ZYL	b	D WEIR	b	B DELPORT	a	CJ FOURIE		
8	a	HR STASSEN	14	c	J LE ROUX	21	c	MESTERHUYZEN		
	b	H STASSEN		d	M LAUBSER		d		b	GA HARPER
9	a	N ELLIS	15	a	J COERT	22	a	FT THEBE		
	b	K ELLIS		b	M JUMBA		a	S WOODBOURNE	a	J GUSHA
	c	B WESSELS		c	W NONTSENCY		b	MJ GIBBERD	b	KG MAHLANGU
	d			d					c	
							d			

PASSENGER CABIN ALLOCATION

VOYAGE NUMBER : 144 End of February **FROM** Antarctica **TO:** Cape Town

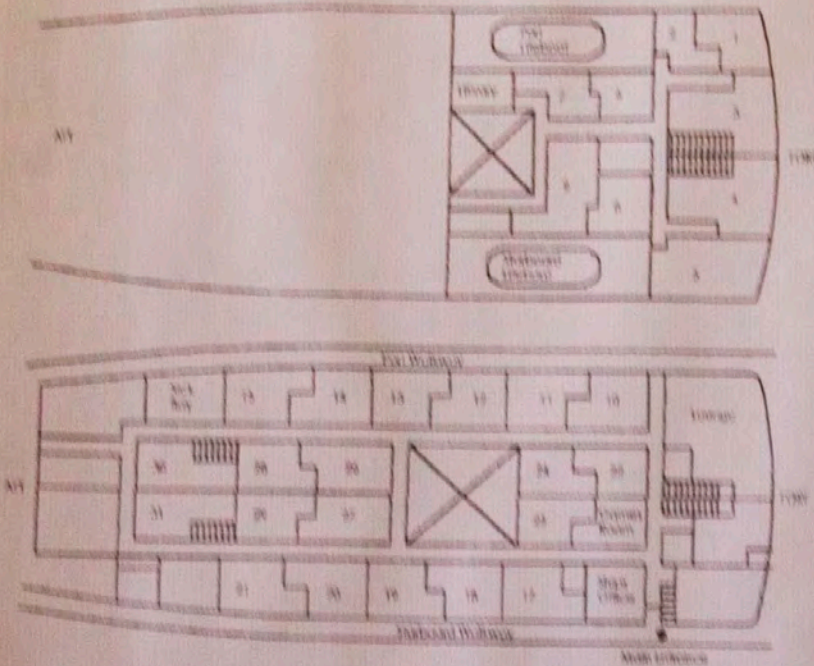

No		NAME	No		NAME	No		NAME
1	a	L MAGNUS	10	a	LSD DU PLESSIS	17	a	J BRITTON
	b	S PILLAY		b	GDH GRUNDLING		b	D JORDAAN
2	a	JA DREYER	11	c	C FOURIE	18	c	C VD MERWE
	a	S THOMALLA		d			d	
3	b	S BREMNER	12	a	RJ DUNCAN	19	a	M ALEXANDROI
	c			b	MR O'KENNEDY		b	M SCHWARZE
4	d		13	c	S NGINDA	20	c	H STEYN
	a	D. HILLAND		d			d	
5	b	B. HILLAND	14	a	AP VAN ZYL	21	a	G MAGAGULA
	c			b	L KRIEDEMANN		b	M SALMANI
6	d		15	c	GJ LAUBSCHER	22	c	
	a	GEG LOUW		d			d	
7	b	GH SMITH	16	a	IS VD BERG	23	a	S RAINIER
	c	B V LOGGENBERG		b	A SCHUTTE		b	M QUELLMALZ
8	d		17	c	H VD WESTHUIZEN	24	c	M SMITH
	a	K CRONJE		d	D DAMSTER		d	E KEAN
9	b	R HOFMEYR (DR)	18	a	M COMMINS	25	a	R BURGO
	a	G VAN ZYL		b	D WEIR		b	B DELPORT
10	a	CA JACOBS	19	c	J LE ROUX	26	c	E KOEN
	b	Z GEBHARDT		d	M LAUBSER		d	
11	a	N ELLIS	20	a	J COERT	27	a	S WOODBOURNE
	b	K ELLIS		b	M JUMBA		b	MJ GIBBERD
12	c	B WESSELS	21	c	W NONTSENGY	28	c	
	d			d			d	
13	a		22	a		29	a	CJ FOURIE
	b			b			b	GA HARPER
14	c		23	c		30	c	M ESTERHUYZEN
	d			d			d	FT THEBE
15	a		24	a		31	a	J GUSHA
	b			b			b	KG MAHLANGU
16	c		25	c		32	c	
	d			d			d	

Annexure E

(Finalized 01 December 2008)